

# IR2-S-4,8/IR2-S-M-4,8

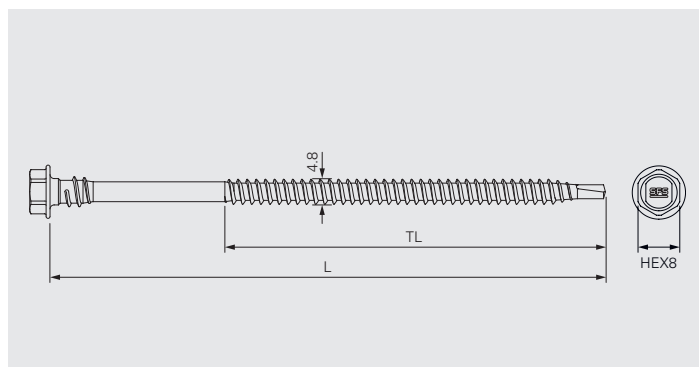

## Application 1

Stainless steel fastener for waterproof membrane and insulation securement on steel deck, loose and belted. For applications with increased requirements, such as high relative humidity, chemical aggressive atmospheres or conditions (e.g. coastal environments). For refurbishments with unknown condition of the existing build-up or build-up with abrasive layers that may damage the corrosion protection. If extended design life and/or warranty is required.

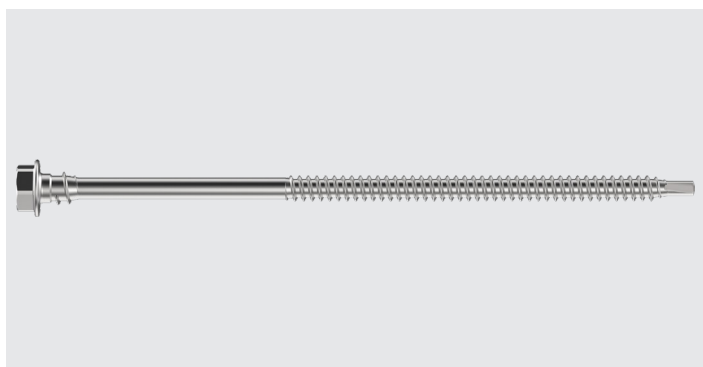
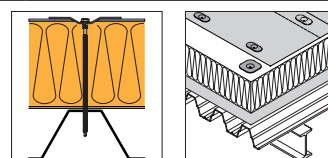

Substrate material quality: S235–S320GD  
 Substrate material thickness: min. 0.6 mm  
 max. 2x1.0 mm  
 Setting depth: min. 20 mm  
 Fastener length L: Clamping length CL + min. 20 mm

## Application 2

Stainless steel fastener for waterproof membrane and insulation securement on timber and timber-based boards, loose and belted. For applications with increased requirements, such as high relative humidity, chemical aggressive atmospheres or conditions (e.g. coastal environments). For refurbishments with unknown condition of the existing build-up or build-up with abrasive layers that may damage the corrosion protection. If extended design life and/or warranty is required.

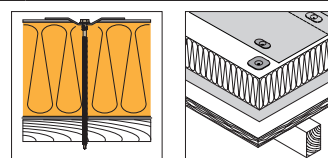

Material thickness: min. 18 mm  
 Setting depth: min. 30 mm  
 Fastener length L: Clamping length CL + min. 30 mm

## Product Information

Material: Austenitic stainless steel, European standard 1.4401, grade A4, AISI 316  
 Drill tip and thread inlet, length 13 mm:  
 Case hardened carbon steel, galvanised

## Approvals/Assessments



Declaration of Performance (DoP)

## Features and Benefits

- Stainless steel quality A4, 1.4401, AISI 316
- Fast and easy installation due to optimised drill tip
- High pull-out values with asymmetric fastener thread
- Environment friendly, free of Chromium VI
- Support thread under the fastener head provides a treadfast fastening system

## Product Range Loose fasteners

| Product Code  | L mm | TL mm | PU  | Material No. |
|---------------|------|-------|-----|--------------|
| IR2-S-4,8×60  | 60   | 45    | 500 | 484741       |
| IR2-S-4,8×80  | 80   | 65    | 500 | 492787       |
| IR2-S-4,8×100 | 100  | 75    | 500 | 492793       |
| IR2-S-4,8×120 | 120  | 75    | 500 | 484743       |
| IR2-S-4,8×140 | 140  | 75    | 250 | 496263       |
| IR2-S-4,8×160 | 160  | 75    | 250 | 496265       |
| IR2-S-4,8×180 | 180  | 75    | 100 | 1258202      |
| IR2-S-4,8×200 | 200  | 75    | 100 | 1258205      |
| IR2-S-4,8×220 | 220  | 75    | 100 | 1258207      |
| IR2-S-4,8×240 | 240  | 75    | 100 | 1258209      |
| IR2-S-4,8×260 | 260  | 75    | 100 | 1258221      |

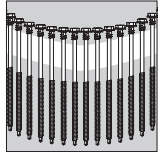

## Belted fasteners



| Product Code    | L <sub>mm</sub> | TL <sub>mm</sub> | PU  | Material No. |
|-----------------|-----------------|------------------|-----|--------------|
| IR2-S-M-4,8×60  | 60              | 45               | 750 | 624867       |
| IR2-S-M-4,8×80  | 80              | 65               | 750 | 624865       |
| IR2-S-M-4,8×100 | 100             | 75               | 750 | 624857       |
| IR2-S-M-4,8×120 | 120             | 75               | 750 | 624858       |
| IR2-S-M-4,8×140 | 140             | 75               | 750 | 624859       |
| IR2-S-M-4,8×160 | 160             | 75               | 750 | 624861       |
| IR2-S-M-4,8×180 | 180             | 75               | 750 | 1614901      |
| IR2-S-M-4,8×200 | 200             | 75               | 750 | 1614909      |
| IR2-S-M-4,8×220 | 220             | 75               | 750 | 1614903      |
| IR2-S-M-4,8×240 | 240             | 75               | 750 | 1614904      |

Installation just possible with IF240, IF240-B

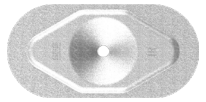
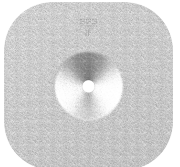
## Products to combine with

| Product Code | Description  |   |
|--------------|--|---|
| IR-82×40     | Stress plate for waterproof membrane and insulation securement.<br>For seam fastening application. |  |
| IF-70×70     | Stress plate for insulation securement.  |  |

## Tools and Accessories

| Product Code | Description   |   |
|--------------|---|---|
| IF240-B      | Automated setting tool for the fast and economic installation of fasteners and stress plates.<br>For belted fasteners IR2-M-4,8 and IR2-S-M-4,8 and stress plates IR-82×40, IF/IG-C-82×40 and IF-70×70. |    |
| ZA¼"         | Drive bar for socket, for manual fastener installation  |   |
| E380-3/8"-34 | Socket for fastener with HEX 8 head, for manual fastener installation   |  |

## Recommendations for Installation

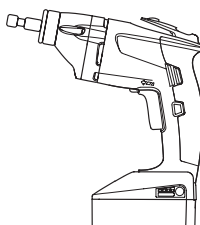
| Operating process | Recommendation  |   |
|-------------------|---|---|
| Screwing in       | <p>Power screwdriver</p> <ul style="list-style-type: none"> <li>• 1000–3000 rpm</li> <li>• Min. 500 W</li> </ul> <p>Battery tool</p> <ul style="list-style-type: none"> <li>• 1000–3000 rpm</li> <li>• Min. 18 V</li> <li>• Battery with min. 2,5 Ah</li> </ul> |  |